

# Presidential Plaza West

Miami-Fort Lauderdale-Pompano Beach, FL

26.228, -80.2221  
7302 Southgate Boulevard | No. Lauderdale, FL 33068

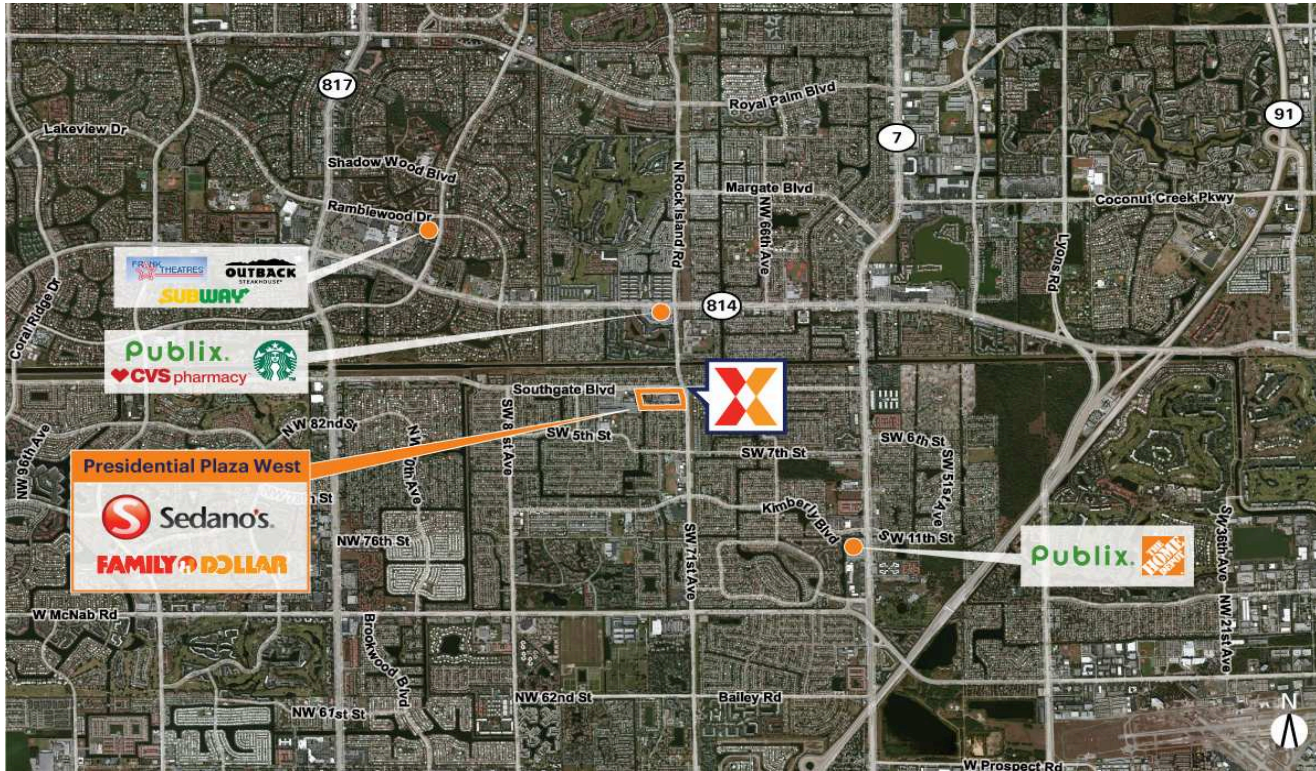

Center Size: 88,441 SF

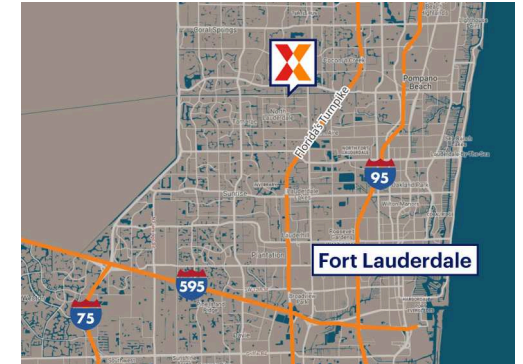

Demographics	1 Mile	3 Mile	5 Mile
	24,586	181,059	445,759
	8,335	70,613	175,213
	\$56,627	\$66,023	\$68,831

Positioned in a densely populated area of Broward County with 181,000+ residents within a 3-mile radius

High visibility on Rock Island Rd from 33,000+ vehicles daily and Southgate Blvd with 26,000+ vehicles

Sedano's-anchored center, easily accessible from two points of ingress/egress

# Presidential Plaza West

Miami-Fort Lauderdale-Pompano Beach, FL

26.228, -80.2221

7302 Southgate Boulevard | No. Lauderdale, FL 33068

## Available Space

22	1,222 SF
25	4,590 SF
31	990 SF

## Current Retailers

N.A.P.	Gas	0 SF
01	O'Reilly Automotive	8,291 SF
06	La Paloma Financial Services And Uhaul	1,583 SF
07	Academy Insurance	1,355 SF
08/09	TLC Dental	1,625 SF
10	Antona Pizza Caf?	1,500 SF
11	Domino's Pizza	1,250 SF
12	Family Dollar	10,000 SF
13	Cricket	1,000 SF
14	Sedano's	34,300 SF
15	Kleen Kutz	1,100 SF
16	Boost Mobile	1,340 SF
17	Green Light Financial Services	960 SF
18/19	Pete's Coin Laundry	1,800 SF
20	MetroPCS	1,300 SF
21	Dryclean USA	1,600 SF
23	Polish Deli Krakus	1,440 SF
24	2, 4, 6 Thrift Store	1,410 SF
26	Christian Church Of Reference	1,300 SF
27	Star Nails	1,335 SF
28	Bistro Creole Restaurant	1,350 SF
29&30	South Rock Beverage	2,760 SF
32	Laundromart	3,040 SF



1134